

**Step #1: Draw a rough outline of your kitchen locating all windows and doors in their respective positions.**

- \* For Doorways with hinged doors, draw the door according to which way it swings.
- \* If you are replacing your cabinets, you do not need to include current cabinet dimensions. However do indicate the precise location including the center line of the sink and appliances that will be staying in their current location.

**Step #2: Label and measure the doors and windows, putting the measurements in the table below.**

- \* When measuring doors and windows, the trim is considered part of the door or window.

**Step #3: Identify and measure unmovable obstructions. (See Example for details.)**

- \* Note the location of the obstruction with a box, such as radiators, pipes, exposed plumbing or vents that you either cannot move or do not want to move.

**Step #4: Measure the ceiling height.**

- \* Sometimes, especially with older homes, it is a good idea to take measurements in a few different areas of the kitchen.

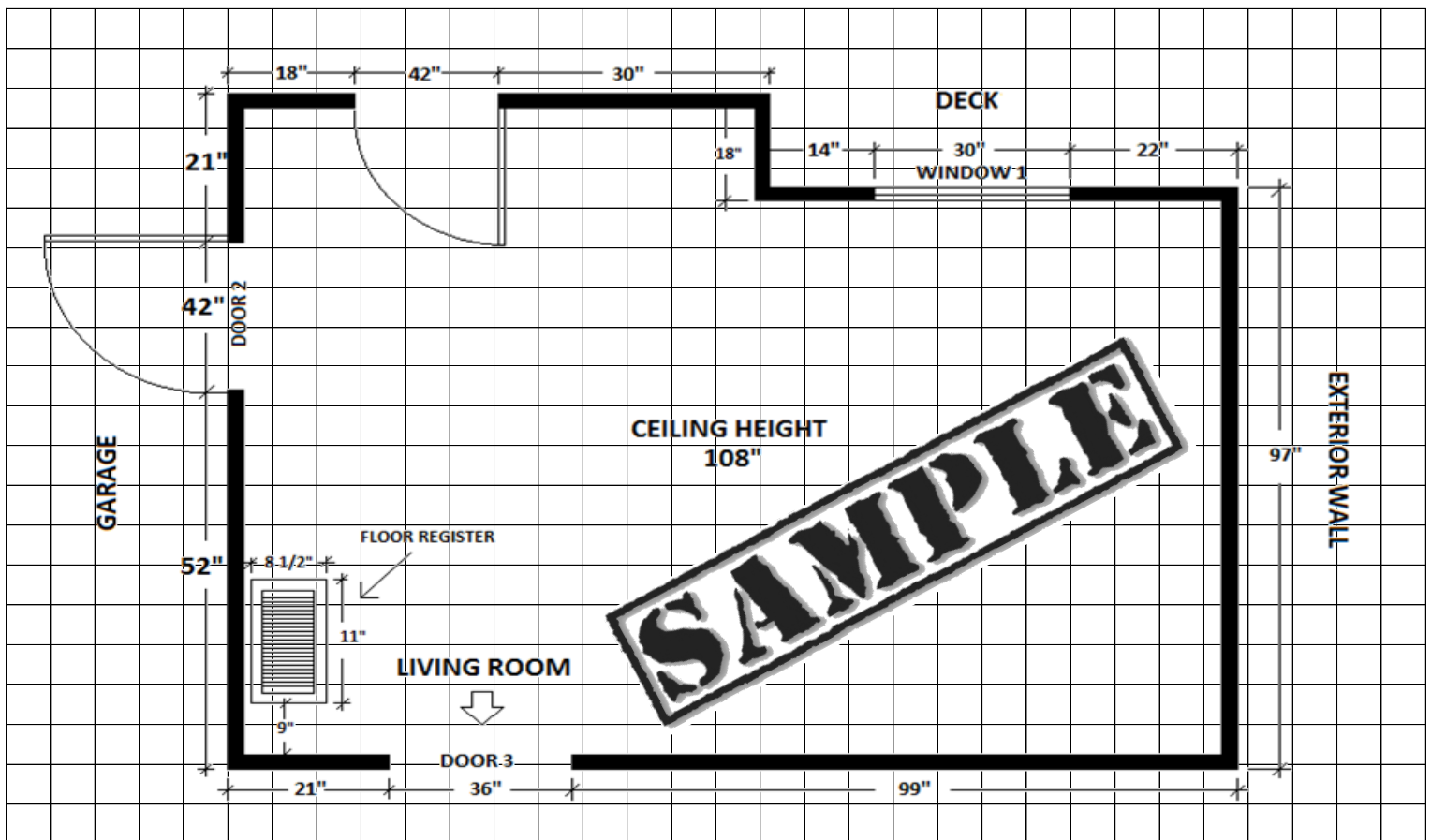

	Distance from Floor to Bottom of Window	Height of Window/ Door Including Trim
Window 1:	44" (inches)	32" (inches)
Window 2:	(inches)	(inches)
Door 1:	(inches)	86 1/2" (inches)
Door 2:	(inches)	86 1/2" (inches)
Door 3:	(inches)	84" (inches)

	Model #	Dimensions
Range:		30" WIDE
Microwave:		30" WIDE 15" TALL
Hood:		
Dishwasher:		24" WIDE
Refrigerator:		36" WIDE 69" TALL



